

## INSTRUCTIONS FOR FIRE DOOR RETAINER

This electromagnet fire door retainer is intended to hold open fire doors fitted with a suitable closing mechanism. The power supply to this door retainer must be controlled by the building's fire detection system. The door will be held open when power is supplied to the unit and released when power is disconnected. This fire door retainer should only be installed by a technically competent person.

### Specifications

Rated Holding Force.....200 newtons.  
 Maximum Holding Force.....250 newtons.  
 Maximum Cable Size stranded....2.5 mm<sup>2</sup>,  
 single.....4.0 mm<sup>2</sup>  
 Residual Holding Force.....Zero.  
 Door closer power size.....3 to 6

Current 24 V dc..... 50 mA,  
 230 V ac..... 12 mA.

CE	Allegion (UK) Limited 35 Rocky Lane, Aston Birmingham, B6 5RQ United Kingdom		05					
	1121-CPD-AE0009	EN1155:1997 + A1:2002	3	5	6 3	1	1	3

### Mounting Instructions

- Decide on suitable mounting positions for the magnet and the keeper plate at least 650 mm from the axis of the door hinge. The keeper plate will adjust through a 30° angle to help alignment with the face of the magnet. The black push switch is used to release the door manually and should be easily accessible when the door is retained open.
- Cable entry can be directly through the back face of the box or through the 20 mm entries provided for surface mounted pyro or conduit.

All 230 V models must be earthed. Check earth continuity after installation. A readily accessible disconnection device must be incorporated into the fixed wiring. If pyro is used a separate earth lead must be connected from the gland to the earth terminal on the magnet body.

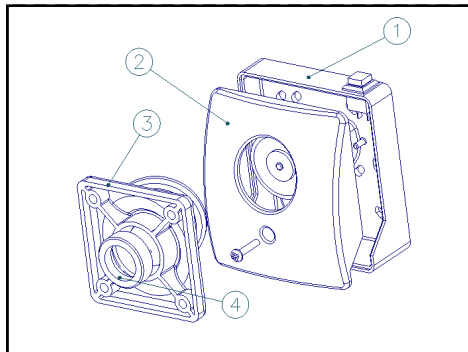

- Fit the lid (2) and secure with the single screw provided.
- Check that the rubber ring (4) is fitted in the base plate (3) before fitting the keeper plate assembly loosely to the door. Adjust the angle to align with the magnet and tighten the mounting screws to lock the plate in place.
- Connect the electrical supply and check the magnet will hold the door open. Check that the door closes when the fire alarm is triggered and when the release switch is pushed.

**NOTE:** Be sure that the action of the door retainer does not cause the door to become permanently warped and prevent it sealing in the closed position

## INSTRUCTIONS FOR FIRE DOOR RETAINER

This electromagnet fire door retainer is intended to hold open fire doors fitted with a suitable closing mechanism. The power supply to this door retainer must be controlled by the building's fire detection system. The door will be held open when power is supplied to the unit and released when power is disconnected. This fire door retainer should only be installed by a technically competent person.

### Specifications

Rated Holding Force.....200 newtons.  
 Maximum Holding Force.....250 newtons.  
 Maximum Cable Size stranded....2.5 mm<sup>2</sup>,  
 single.....4.0 mm<sup>2</sup>  
 Residual Holding Force.....Zero.  
 Door closer power size.....3 to 6

Current 24 V dc..... 50 mA,  
 230 V ac..... 12 mA.

CE	Allegion (UK) Limited 35 Rocky Lane, Aston Birmingham, B6 5RQ United Kingdom		05					
	1121-CPD-AE0009	EN1155:1997 + A1:2002	3	5	6 3	1	1	3

### Mounting Instructions

- Decide on suitable mounting positions for the magnet and the keeper plate at least 650 mm from the axis of the door hinge. The keeper plate will adjust through a 30° angle to help alignment with the face of the magnet. The black push switch is used to release the door manually and should be easily accessible when the door is retained open.
- Cable entry can be directly through the back face of the box or through the 20 mm entries provided for surface mounted pyro or conduit.

All 230 V models must be earthed. Check earth continuity after installation. A readily accessible disconnection device must be incorporated into the fixed wiring. If pyro is used a separate earth lead must be connected from the gland to the earth terminal on the magnet body.

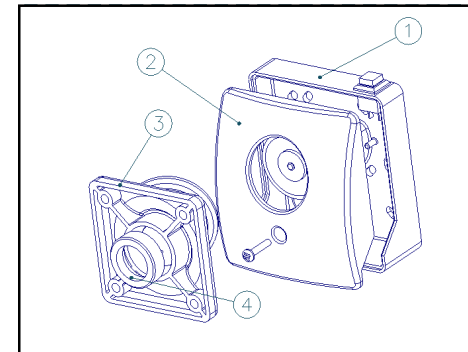

- Fit the lid (2) and secure with the single screw provided.
- Check that the rubber ring (4) is fitted in the base plate (3) before fitting the keeper plate assembly loosely to the door. Adjust the angle to align with the magnet and tighten the mounting screws to lock the plate in place.
- Connect the electrical supply and check the magnet will hold the door open. Check that the door closes when the fire alarm is triggered and when the release switch is pushed.

**NOTE:** Be sure that the action of the door retainer does not cause the door to become permanently warped and prevent it sealing in the closed position